

VIKING EXPEDITION SHIPS

Viking Octantis / Viking Polaris

Below are the floor plans for the different staterooms, as well as the sizes and details on what is included in each stateroom category. The colours beside each stateroom category correspond to those in the deck plans on the following pages.

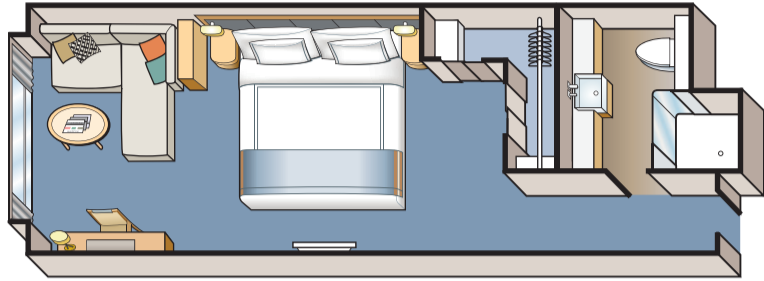

NORDIC BALCONY

■ ■ N1-N2 | 222 sq. ft. (21 sq. m)

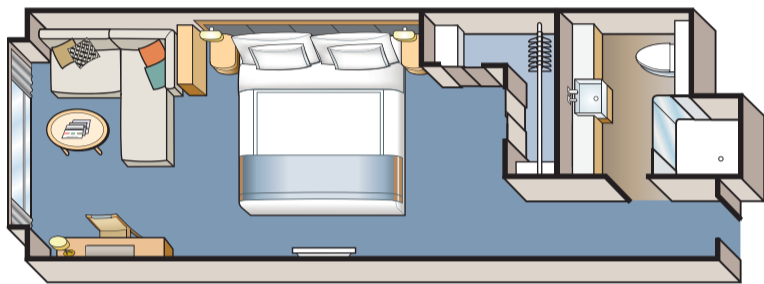

DELUXE NORDIC BALCONY

■ ■ ■ DN1-DN3 | 222 sq. ft. (21 sq. m)

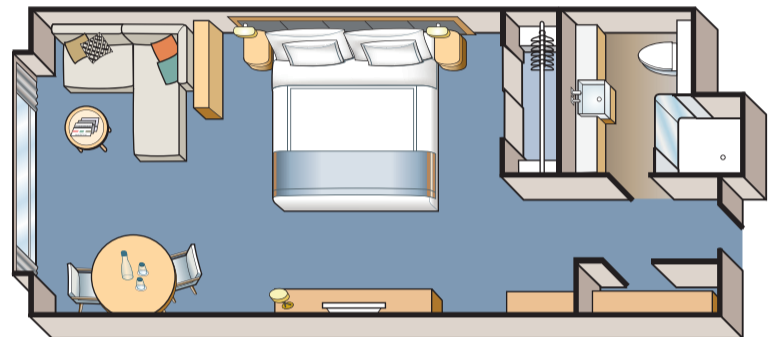

NORDIC PENTHOUSE

■ NP | 269 sq. ft. (25 sq. m)

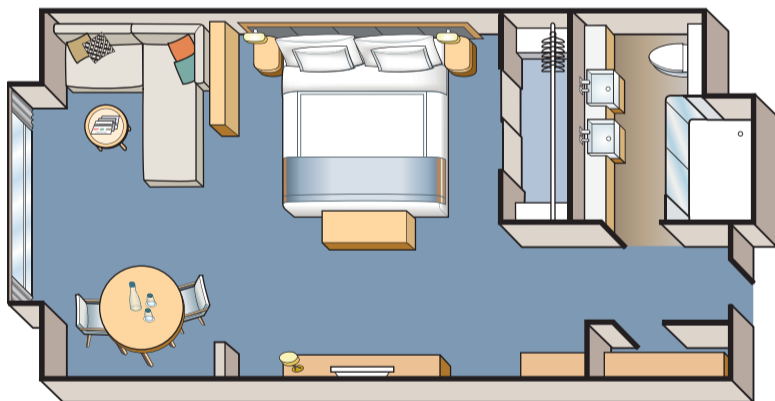

NORDIC JUNIOR SUITE

■ NS | 322 sq. ft. (30 sq. m)

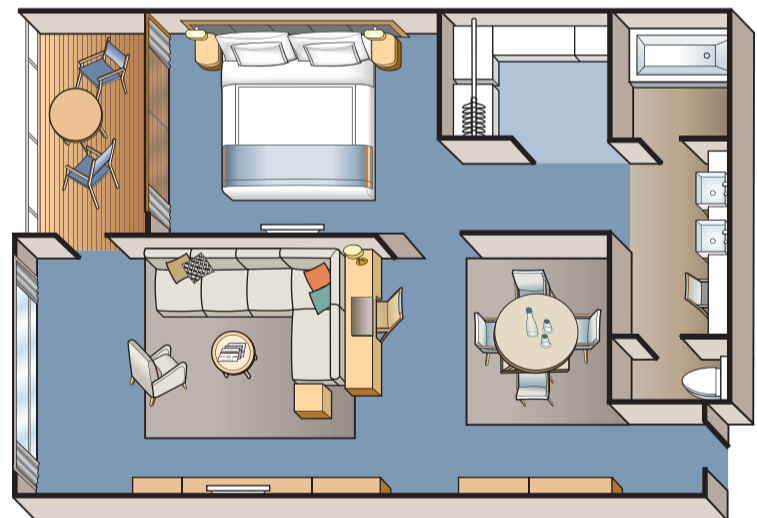

EXPLORER SUITE

■ ES | 580 sq. ft. (54 sq. m)



OWNER'S SUITE

■ OS | 1,223 sq. ft. (114 sq. m)