





WELCOME
ON BOARD



The Sisterships

Ships on a human scale.
With just 122 or 132 staterooms
and suites *Le Boréal*, *L'Austral*,
Le Soléal and *Le Lyrial* are compact
enough to gain access to isolated places
and ports reserved for small vessels.

They are thus faithful
to the PONANT DNA:
exploring the world
with constantly
renewed curiosity.





1. Spa, *Le Lyrial*
2. The gastronomic Restaurant, deck 2, *Le Lyrial*
3. The swimming pool on deck 6
4. The Observatory lounge, *Le Boréal*
5. The library

6. *Le Boréal*
7. Prestige Stateroom, *Le Lyrial*
8. Prestige Stateroom Balcony, *Le Boréal*
9. Prestige Stateroom, *L'Austral*

Amenities

- Exclusive, tailor made services for guests in the Owner Suites, thanks to the assistance of our Concierge service
- Individually controlled airconditioning
- Stateroom layout: king-size bed, or twin beds, communicating Staterooms available (children welcome)
- Minibar
- Flat-screen satellite TV
- Video on demand
- Bose Bluetooth speaker

- Safe
- Diptyque bath products
- Dressing table, bath robes, hairdryer
- Direct line telephone
- 110V American (two flat pins)/220V European (round sockets with two round pins)
- 24hr room service
- Inclusive Wifi internet access*

**Depending on the navigation areas, the Wifi may not be accessible for reasons beyond our control.*

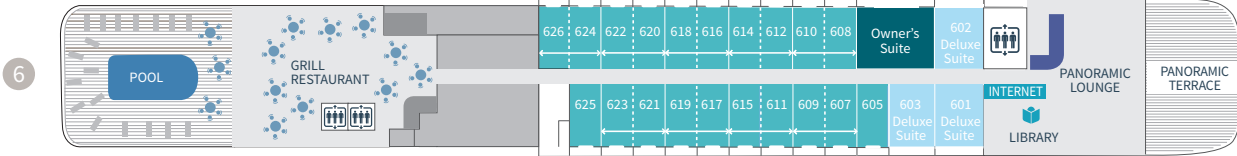
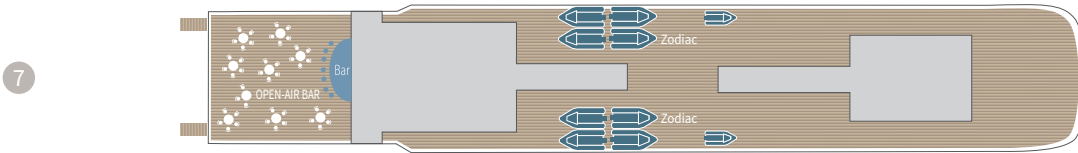

Le Lyrial

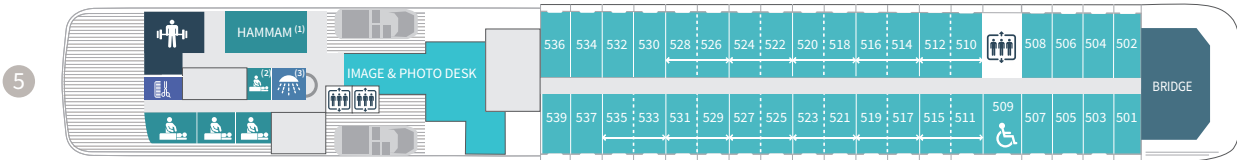

Configuration: L'Austral: ⁽¹⁾ Locker ⁽²⁾ Hamman ⁽³⁾ Locker • Le Boréal: ⁽¹⁾ Massage ⁽²⁾ Hamman ⁽³⁾ Locker • Le Soléal: ⁽¹⁾ Hammam ⁽²⁾ Locker ⁽³⁾ Locker.

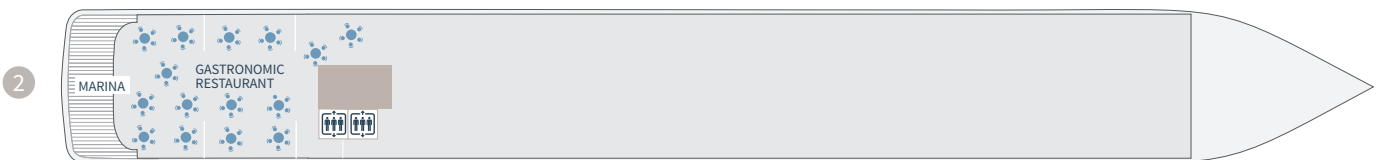
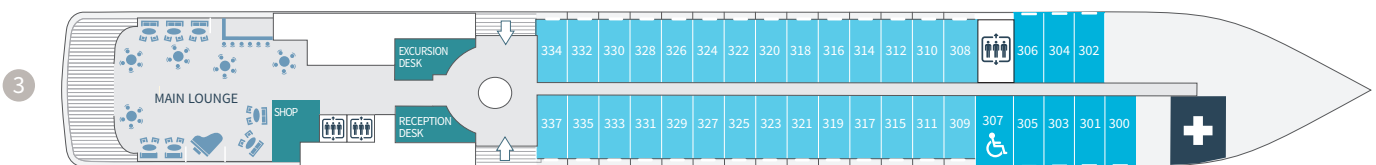
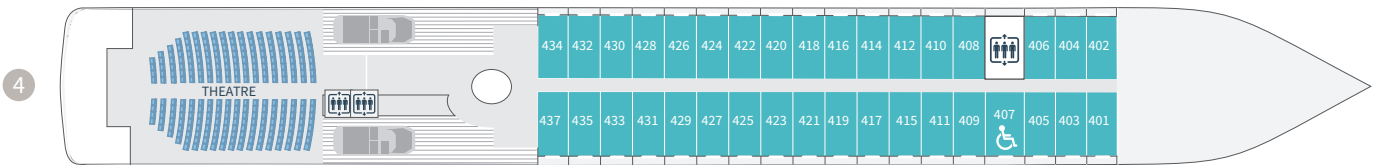

Scan the QR code to see more of our Sisterships

- Owner's Suite Deck 6
- Grand Privilege Suite Deck 6 (Le Lyrial)
- Privilege Suites Deck 6 (Le Lyrial)
- Prestige Suites Deck 5 - 6 (except Le Lyrial)
- Grand Deluxe Suite Deck 6 (Le Lyrial)
- Deluxe Suites Deck 6
- Prestige Staterooms Deck 4 - 5 - 6
- Deluxe Staterooms Deck 3
- Superior Staterooms Deck 3

Discover your Stateroom

OWNER'S SUITE aboard *Le Lyrial*

(55 sq.m/581 sq.ft + 12 sq.m/129 sq.ft private balcony with sliding bay windows)

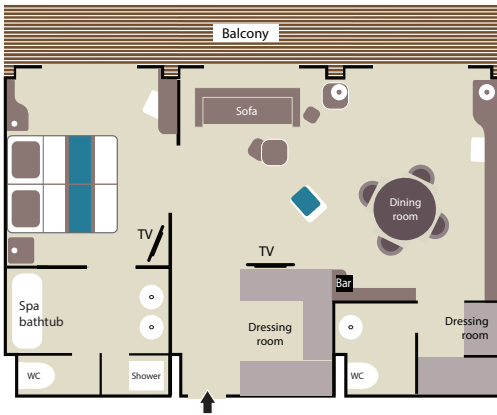

Suite de l'Armateur - LYRIAL

GRAND PRIVILEGE SUITE aboard *Le Lyrial*

(55 sq.m/581 sq.ft + 12 sq.m/129 sq.ft private balcony with sliding bay windows)

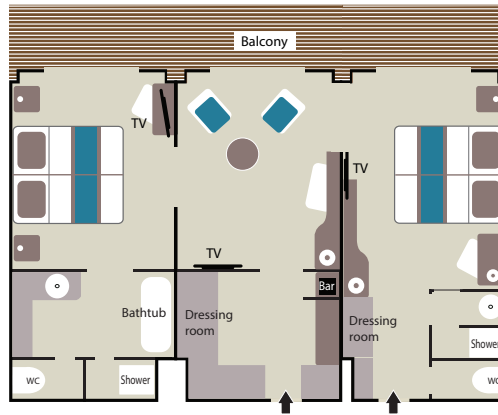

Suite Grand Privilège - LYRIAL

PRIVILEGE SUITE aboard *Le Lyrial*

(37 sq.m/388 sq.ft + 8 sq.m/86 sq.ft private balcony with sliding bay windows)

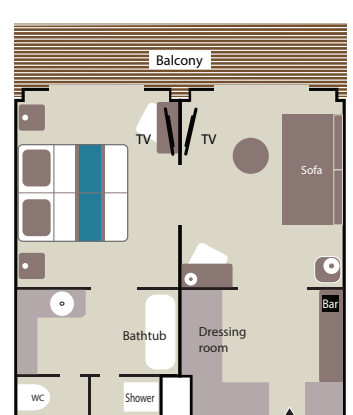

Suite Privilège - LYRIAL

OWNER'S SUITE

(45 sq.m/484 sq.ft + 9 sq.m/97 sq.ft private balcony with sliding bay windows)

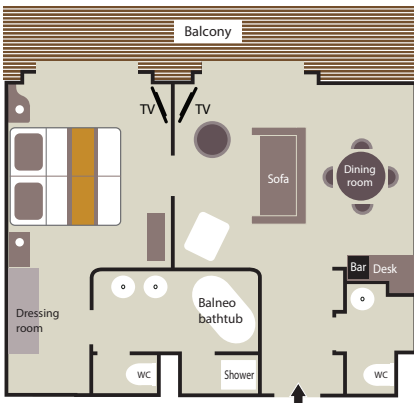

GRAND DELUXE SUITE aboard *Le Lyrial*

(45 sq.m/484 sq.ft + 10 sq.m/108 sq.ft private balcony with sliding bay windows)

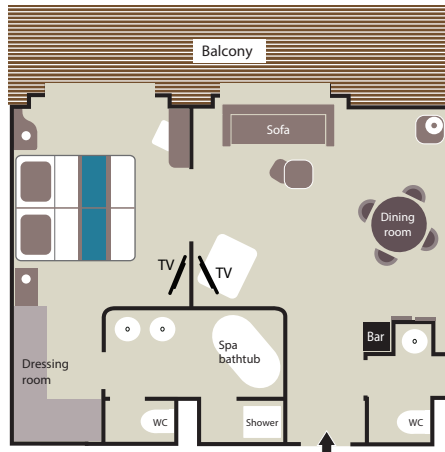

PRESTIGE SUITE

(37 sq.m/398 sq.ft + 8 sq.m/86 sq.ft private balcony with sliding bay windows)

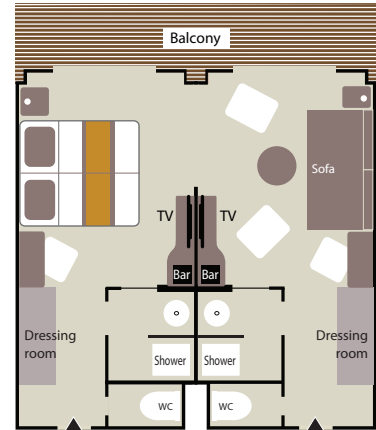

Prestige Suites aboard *Le Boréal* & *Le Soléal*: 1 shower and 1 bathtub.

DELUXE SUITE

(27 sq.m/290 sq.ft + 6 sq.m/64 sq.ft private balcony with sliding bay window)

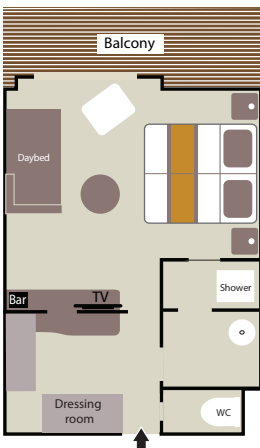

Deluxe Suites aboard *Le Boréal*: 1 shower and 1 bathtub

PRESTIGE STATEROOM

(18.5 sq.m/200 sq.ft + 4 sq.m/43 sq.ft private balcony with sliding bay window)

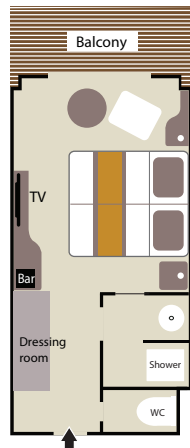

Deck 4

Deck 5-6

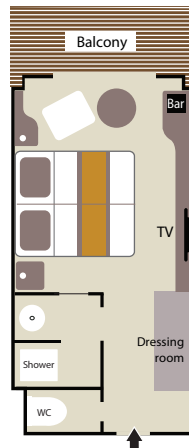

Prestige Staterooms aboard *Le Boréal* & *Le Soléal*, decks 5 & 6: 1 shower or bathtub depends on cabins

DELUXE STATEROOM

(18 sq.m/200 sq.ft + 4 sq.m/43 sq.ft private balcony with French window)

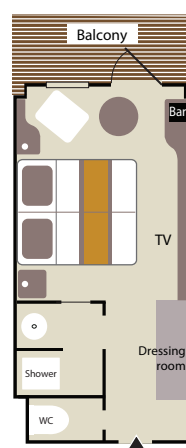

SUPERIOR STATEROOM

(21 sq.m/226 sq.ft)

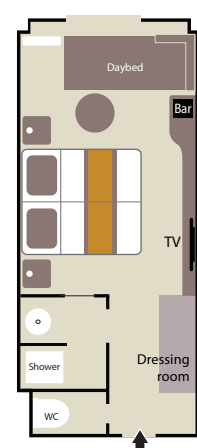



The PONANT Explorers

Equipped with only 92 staterooms and suites, an **underwater lounge**, the *Blue Eye*, and the latest technologies to limit the impact on the environment, *Le Lapérouse*, *Le Champlain*, *Le Bougainville*, *Le Dumont-d'Urville*, *Le Bellot* and *Le Jacques-Cartier* enable you to make ecologically responsible stopovers in remote regions.





1. The Blue Eye, underwater lounge
2. The Spa, in partnership with Sothys or Clarins
3. The pool deck and its solarium
4. The panoramic restaurant, open to the outside
5. The theatre, where conferences, shows and performances take place

6. Le Bougainville
7. The Owner's Suite
8. The Owner's Suite, its private terrace and hot tub
9. Prestige Suite living room, Le Lapérouse

Amenities

- Exclusive, tailor made services for guests in the Owner Suites, thanks to the assistance of our Concierge service
- Individually controlled airconditioning
- Stateroom layout: king-size bed, or twin beds, communicating Staterooms available (children welcome)
- Minibar
- Flat-screen satellite TV
- Video on demand
- Bose Bluetooth speaker
- Safe

- Diptyque bath products
- Dressing table, bath robes, hairdryer
- Direct line telephone
- 110V American (two flat pins)/220V European (round sockets with two round pins)
- 24hr room service
- Inclusive Wifi internet access*

**Depending on the navigation areas, the Wifi may not be accessible for reasons beyond our control.*

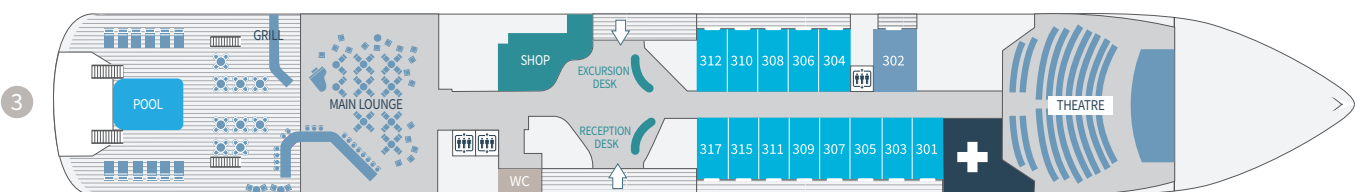
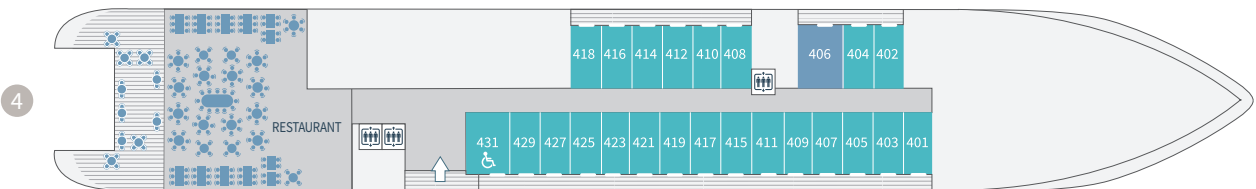
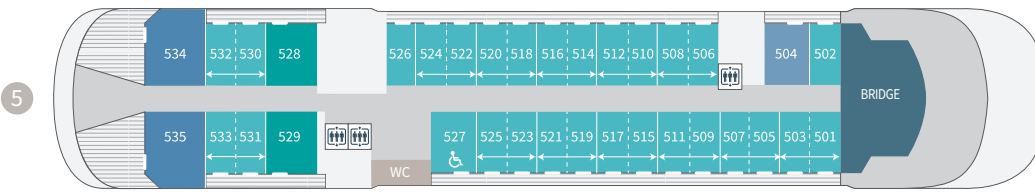
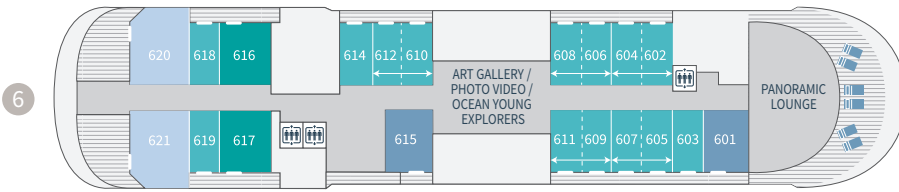
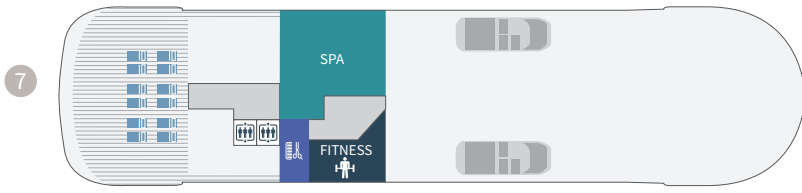

- Owner's Suites
Deck 5
- Grand Deluxe Suites
Deck 6
- Deluxe Suites
Deck 3 - 4 - 5 - 6
- Deluxe Staterooms
Deck 3
- Privilege Suites
Deck 5 - 6
- Prestige Suites
Deck 5 - 6
- Prestige Staterooms
Deck 4 - 5 - 6

Discover your Stateroom

OWNER'S SUITE

(45 sq.m/484 sq.ft + 40 sq.m/430 sq.ft private terrace with hot tub and sliding bay windows)

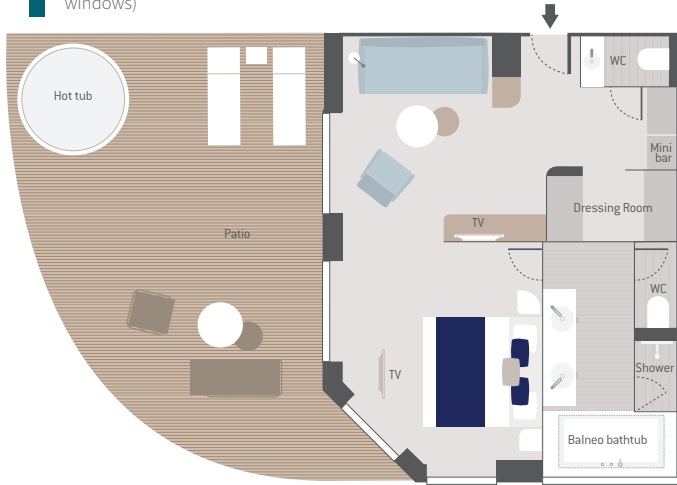

GRAND DELUXE SUITE

(45 sq.m/484 sq.ft + 30 sq.m/323 sq.ft private terrace with sliding bay windows)

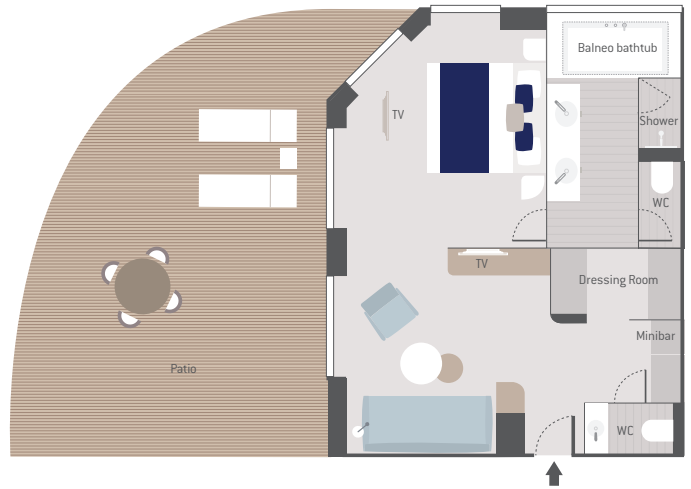

PRIVILEGE SUITE

(32 sq.m/344 sq.ft + 8 sq.m/86 sq.ft private balcony with sliding bay window)



PRESTIGE SUITE

(38 sq.m/409 sq.ft + 8 sq.m/86 sq.ft private balcony with sliding bay window)

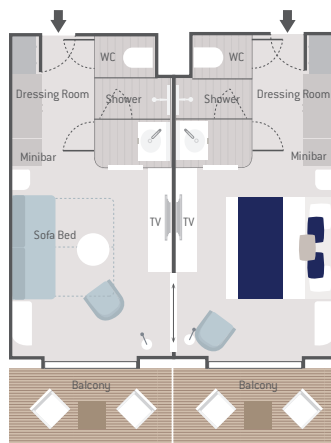

PRESTIGE STATEROOM

(19 sq.m/204 sq.ft + 4 sq.m/43 sq.ft private balcony with sliding bay window)



DELUXE SUITE

(27.5 sq.m/291 sq.ft + 6 sq.m/65 sq.ft private balcony with sliding bay window)

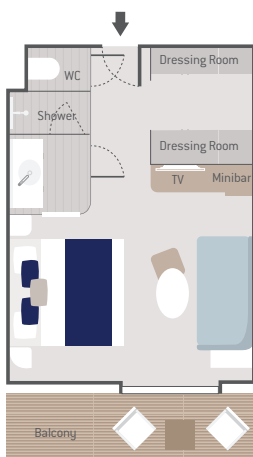

DELUXE STATEROOM

(19 sq.m/204 sq.ft + 4 sq.m/43 sq.ft private balcony with French window)

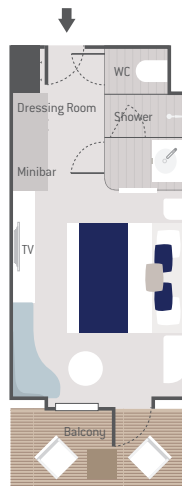

Scan the QR code to see more of our Explorers





Le Commandant Charcot

As the world's first hybrid-electric luxury icebreaker, powered by liquified natural gas, *Le Commandant Charcot* encapsulates an **eco-friendly design** never before seen in the polar regions.

Furnished with 123 staterooms and suites, in total communion with nature, it will carry you safely and comfortably beyond known lands.

Two research laboratories on board enable scientists to collect data that will increase our knowledge of the polar regions.

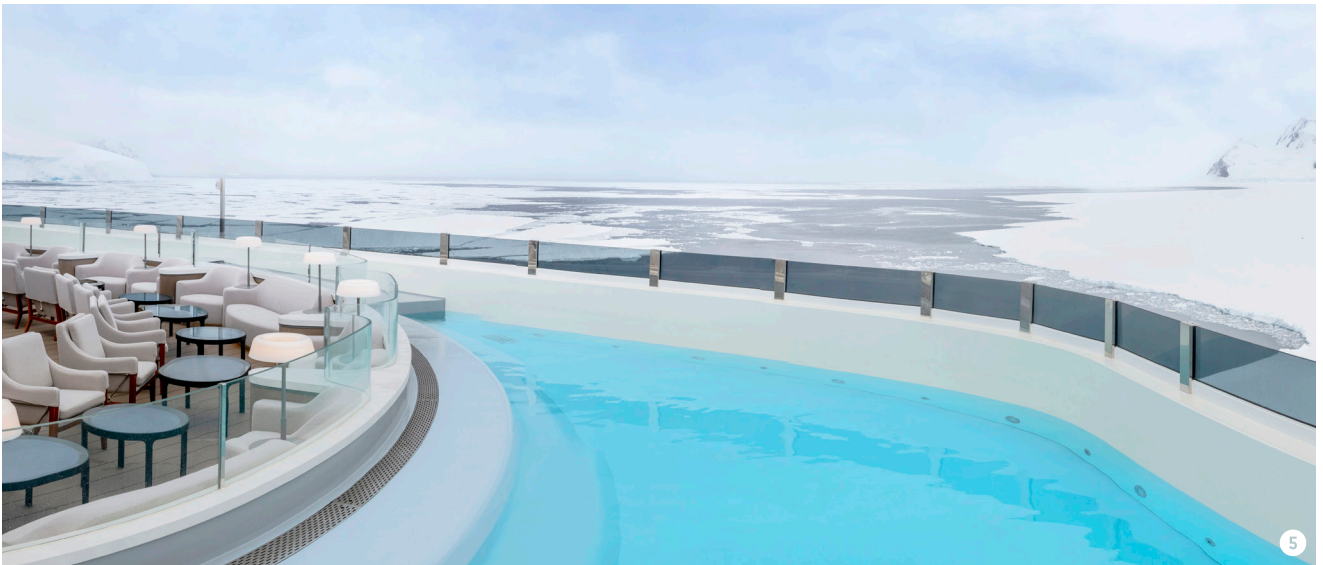
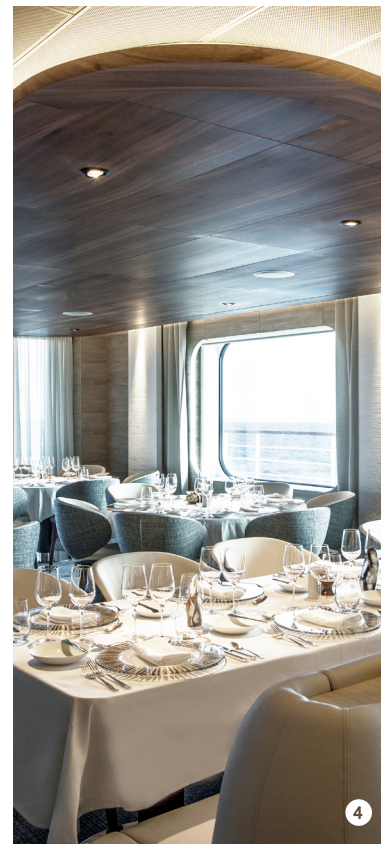

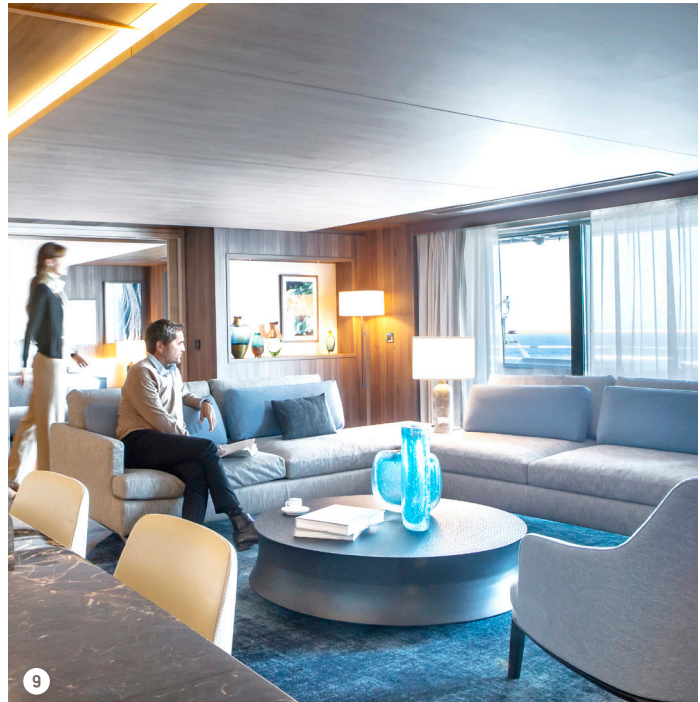

1. The sauna in the wellness area, which also includes the Biological Recherche Spa, hair and nail salon, fitness room, snow cabin
2. The relaxation area, with a heated indoor swimming pool and a detox bar
3. The Panoramic lounge, deck 9
4. Nuna Gastronomic Restaurant, Alain Ducasse's only restaurant at sea
5. The Blue Lagoon area, deck 9

6. *Le Commandant Charcot*
7. The Owner's Suite patio, deck 8
8. The sleeping area on the Duplex Suite
9. The Owner's Suite living room, deck 8

Amenities

- Exclusive, tailor made services for all guests, thanks to the assistance of our Concierge service
- Private balcony for all our Staterooms and Suites
- Terrace for the Duplex Suites and the Owner's Suite
- Butler service and priority boarding: Owner's Suite, Duplex Suites, Privilege Suites and Grand Prestige Suites
- Individually controlled airconditioning
- Stateroom layout: king-size bed, or twin beds, communicating staterooms available (children welcome)
- Minibar and 24hr room service
- Satellite TV channels (availability dependent on navigation)

- Videos on demand
- Bose Bluetooth speaker
- Safe
- Selection of Diptyque bath products
- Dressing table, bath robes, hairdryer
- Direct line telephone
- 110V American (two flat pins)/220V European (round sockets with two round pins)
- Inclusive Wifi internet access*

**Depending on the navigation areas, the Wifi may not be accessible for reasons beyond our control.*

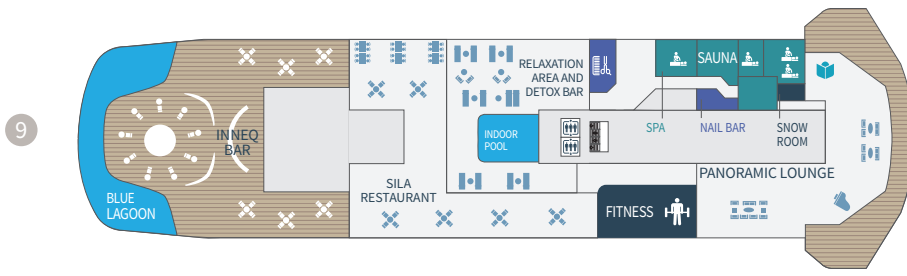

- Owner's Suite
- Duplex Suites
- Privilege Suites Deck 8
- Grand Prestige Suites Deck 6
- Prestige Suites Deck 7 - 8
- Deluxe Suites Deck 6 - 7 - 8
- Prestige Staterooms Deck 6 - 7 - 8

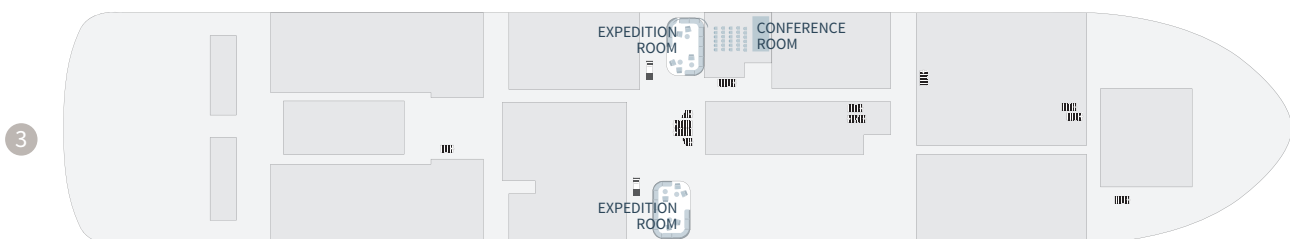
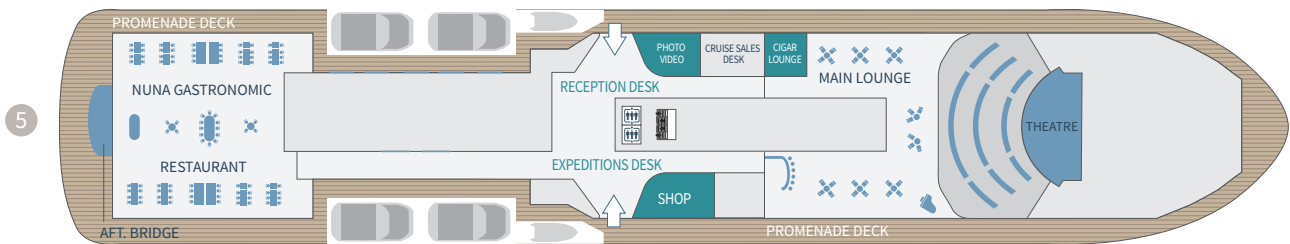
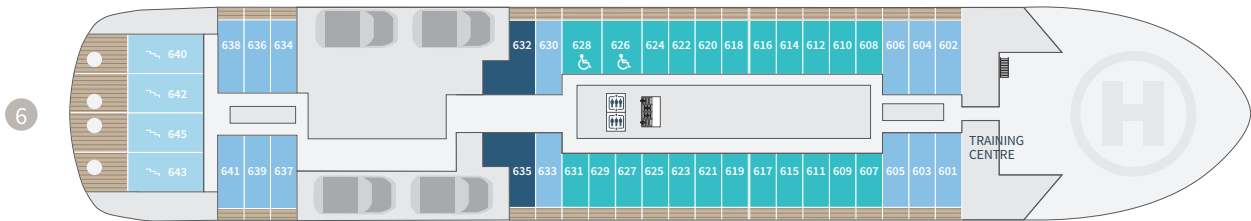
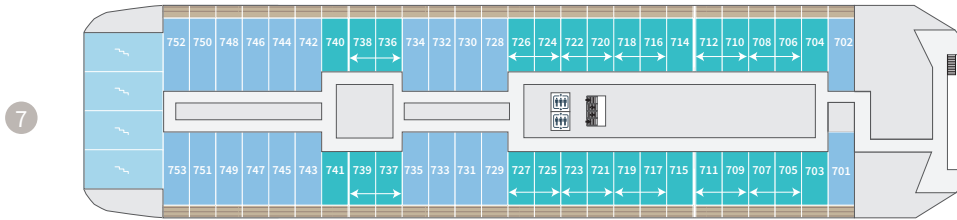
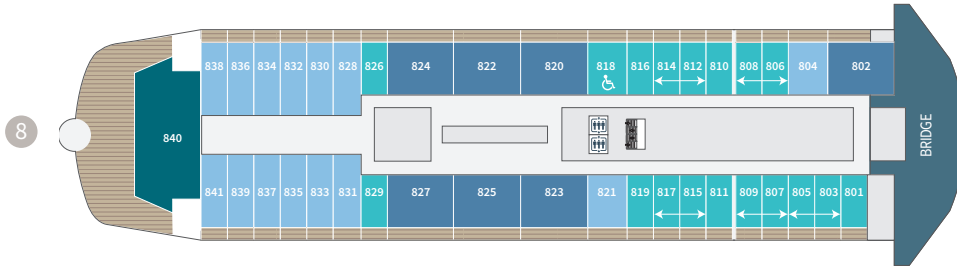

Discover your Stateroom

OWNER'S SUITE (115 sq.m/1,237 sq.ft + 186 sq.m/2,002 sq.ft private terrace with hot tub • balneo bathtub)

GRAND PRESTIGE SUITE (42 sq.m/452 sq.ft + 5 sq.m/54 sq.ft private balcony)

OWNER'S SUITE

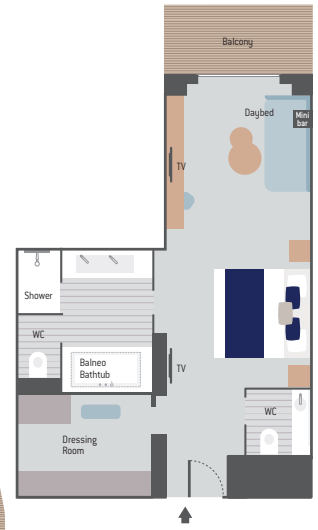

PRIVILEGE SUITE (48 sq.m/516 sq.ft + 12.5 sq.m/134.5 sq.ft private balcony • balneo bathtub)

PRESTIGE SUITE (40 sq.m/430 sq.ft + 10 sq.m/107 sq.ft private balcony)

DUPLEX SUITE (94 sq.m/1,011 sq.ft + 26 sq.m/279 sq.ft private terrace with hot tub • balneo bathtub)

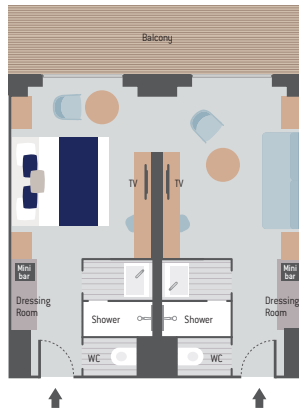
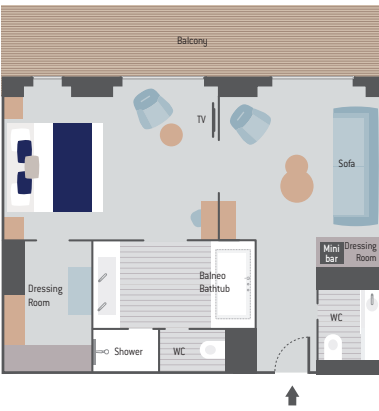

DELUXE SUITE (28 sq.m/301 sq.ft + 5 sq.m/53 sq.ft private balcony)

PRESTIGE STATEROOM (20 sq.m/215 sq.ft + 5 sq.m/53 sq.ft private balcony)

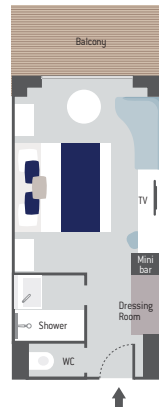

Scan the QR code to see more of *Le Commandant Charcot*.





Le Ponant

It is with this yacht that
the **PONANT** adventure began
35 years ago.

Freshly refurbished, *Le Ponant* reinvents
the art of sailing by going with the
flow: authentic, intimate, hedonistic.
Whether you're passionate about
sailing or a fan of *la dolce vita*,
you will enjoy the pleasure
of a seamless reconnection with the
elements, against a backdrop
of magnificent scenery.

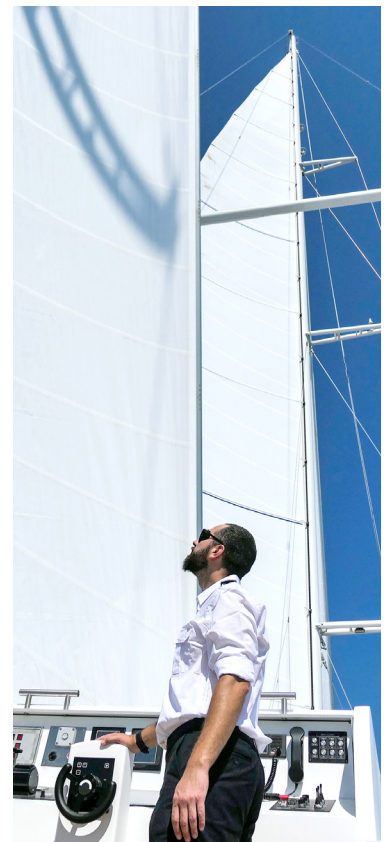

Discover your Stateroom

OWNER'S SUITE

(47 sq.m/506 sq.ft + 9 sq.m/97 sq.ft private balcony)



PRESTIGE MISTRAL SUITE

(27 sq.m/291 sq.ft + porthole)

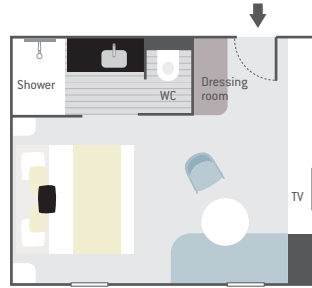

JUNIOR MISTRAL SUITE

(22 sq.m/237 sq.ft + porthole)

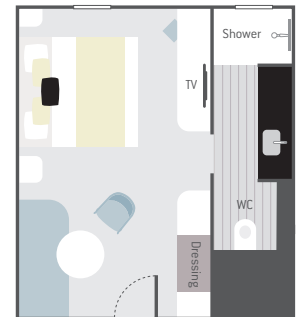

PRESTIGE MISTRAL STATEROOM

(16 sq.m/172 sq.ft + porthole)

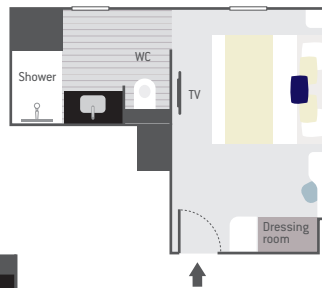

MISTRAL STATEROOM

(14 sq.m/151 sq.ft + porthole)



ALIZES GRAND PRIVILEGE SUITE

(49 sq.m/527 sq.ft + 13 sq.m/140 sq.ft private balcony)

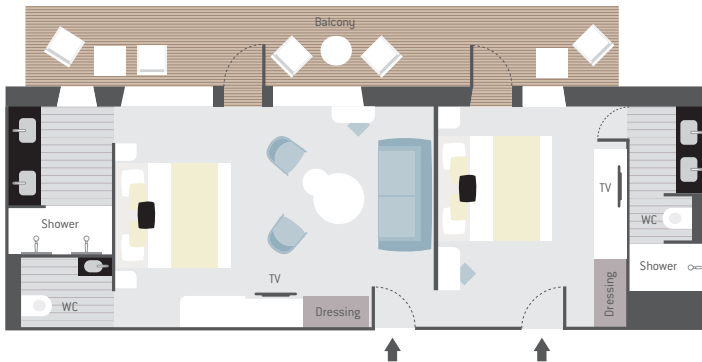

ALIZES PRIVILEGE SUITE

(30 sq.m/323 sq.ft + 9 sq.m/97 sq.ft private balcony)

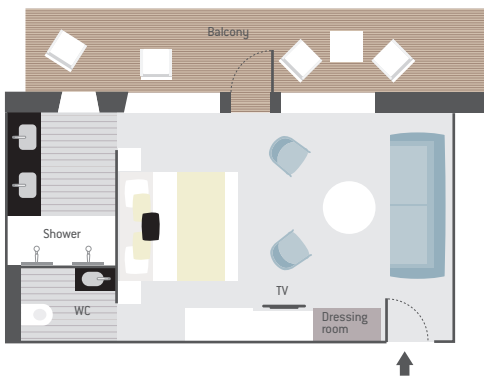

ALIZES STATEROOM

(19 sq.m/205 sq.ft + 4 sq.m/43 sq.ft private balcony)

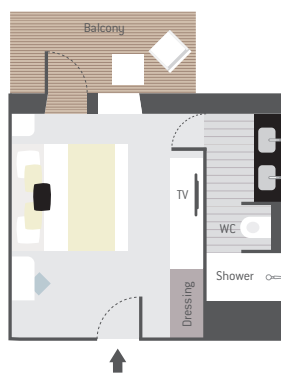

ALIZES PRESTIGE STATEROOM

(16 sq.m/172 sq.ft + 8 sq.m/86 sq.ft private balcony)

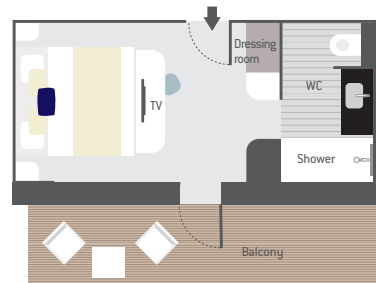

Scan the QR code to see more of *Le Ponant*.





Le Paul Gauguin

The **165 staterooms and suites** of *Le Paul Gauguin* all benefit from **exterior views** and are tastefully furnished and decorated.

The use of **fine materials** such as premium wood and *tiki* design elements pays homage to Polynesian culture and combines elegantly with bright pop art colours. The atmosphere on board is suffused with its inimitable style, which permeates into the cruise experience. Result: the ambience is relaxed and easy going!





1. The Grill restaurant, on deck 8
2. The swimming pool area, for relaxing in the sunshine, also features a bar
3. The Algothem Spa, for treatments and massages based on marine cosmetics
4. L'Étoile gastronomic restaurant
5. The terrace of La Palette lounge, on deck 8

6. Le Paul Gauguin
7. GS Grand Suite
8. The Owner's Suite 701
9. B Veranda stateroom

Amenities

- Exclusive, tailor made services for guests in the Owner Suites, thanks to the assistance of our Concierge service
- Queen-size, king-size bed, or two single beds; some staterooms also have a sofa bed
- Minibar, telephone and safe
- 110 V/220 V electrical sockets
- Flat-screen TV and videos on demand
- Individual airconditioning

- Marble bathroom with bathtub (except seven staterooms with shower only)
- Algothem toiletries and hairdryer
- 24-hour service
- Butler service for the Owner's Suites, the GS Grand Suites, A and B Veranda Suites and Staterooms
- Free Wi-Fi access*

*Depending on the navigation areas, the Wi-Fi may not be accessible for reasons beyond our control.

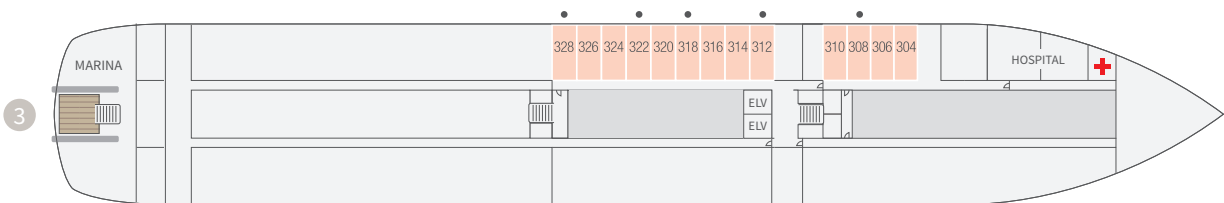
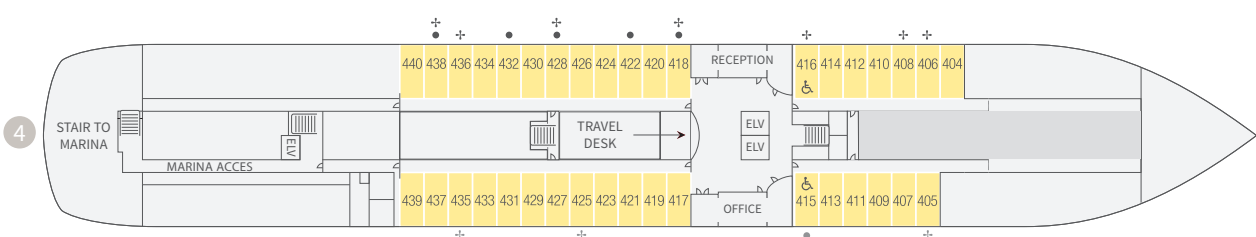
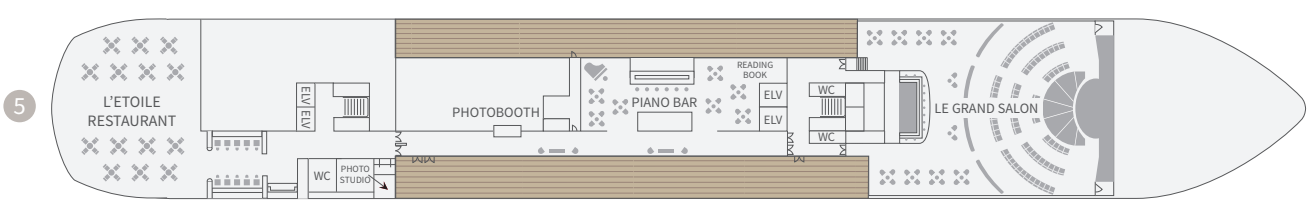
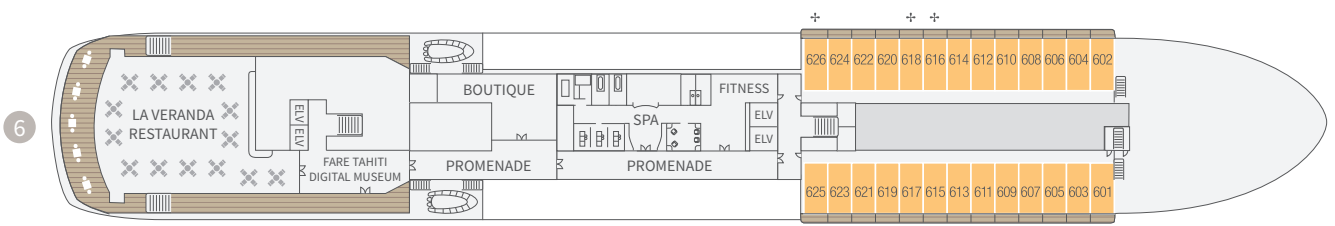
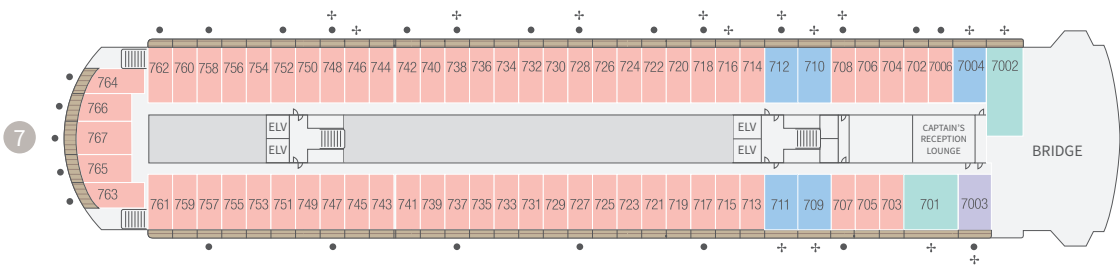
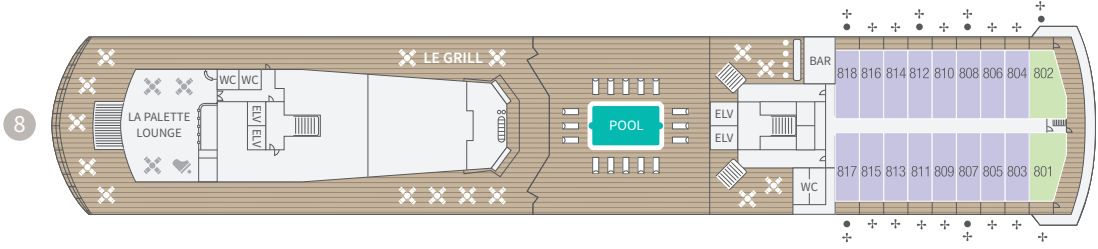
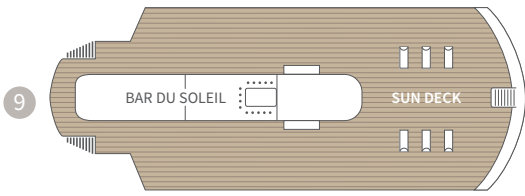

- Owner's Suites
Deck 7 (2)
- Grand Suites
Deck 8 (2)
- Veranda Suites
Deck 7 (5)
- Veranda Staterooms
Deck 8 (16)
- Staterooms with balcony
Deck 7 (63)
- Staterooms with balcony
Deck 6 (26)
- Window Staterooms
Deck 4 (37)
- Porthole Staterooms
Deck 3 (13)

- Denotes stateroom with twin beds that convert to a large double bed.
- + Denotes stateroom with triple occupancy.
- ♿ Staterooms 415 and 416 are wheelchair accessible.

The sofa beds are slightly smaller than the standard twin beds.
Suites and staterooms range from 200 to 588 square feet.
This measurement includes balconies and verandas in categories D and above.

Discover your Stateroom

OWNER'S SUITE 701

(42 sq.m/457 sq.ft + 7 sq.m/77 sq.ft veranda)
The bathroom boasts a separate shower and a dressing area.

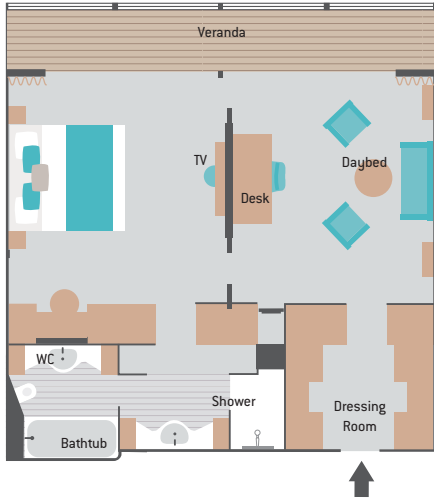

OWNER'S SUITE 702

(49 sq.m/531 sq.ft + 5 sq.m/57 sq.ft veranda)
The bathroom boasts a bathtub and a dressing area.

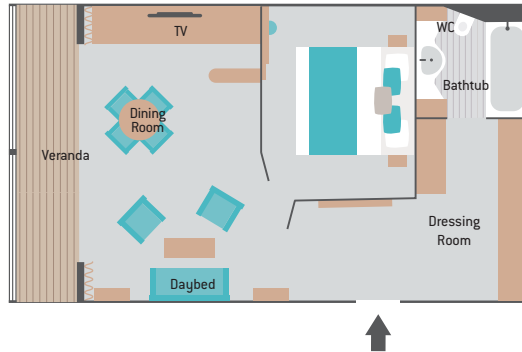

GS GRAND SUITE

(30 sq.m/332 sq.ft + 18 sq.m/197 sq.ft veranda)
Two suites available: the Paul Gauguin Suite (801) and the Flora Tristan Suite (802).

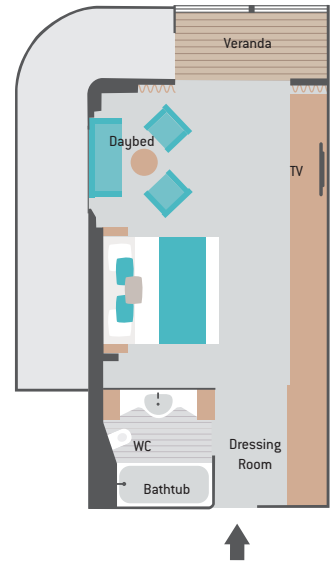

A VERANDA SUITE

(28 sq.m/300 sq.ft + 5 sq.m/58 sq.ft veranda)
Suites available: Tahiti Suite (709), Pont-Aven Suite (710), Atuona Suite (711), Arles Suite (712).

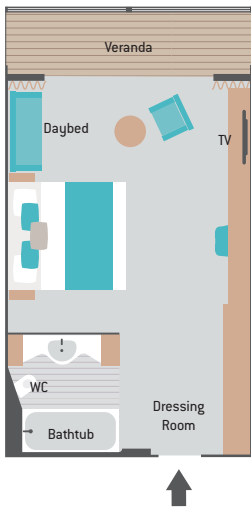

B VERANDA STATEROOM

(24 sq.m/249 sq.ft + 5 sq.m/56 sq.ft veranda)
Cabin 7003 has a shower cubicle and a double bed.

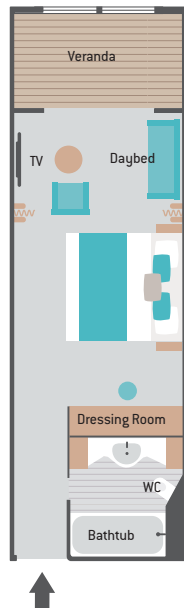

C BALCONY STATEROOM

(19 sq.m/202 sq.ft + 3 sq.m/37 sq.ft balcony)
Balcony Staterooms 708, 716, 718, 728, 738, 746 and 748 can accommodate a guest in a sofa bed. Stateroom 7006 features a very small bathroom with shower only. Staterooms 763, 764, 765, 766 and 767 vary in size and feature shower stall with no tub.

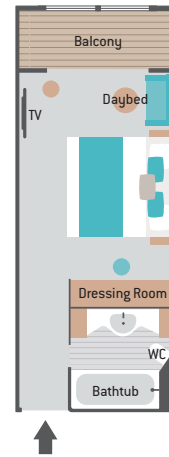

D BALCONY STATEROOM

(19 sq.m/202 sq.ft + 3 sq.m/37 sq.ft balcony)
The following Balcony Staterooms can accommodate a guest in a sofa bed: 616, 618 and 626.

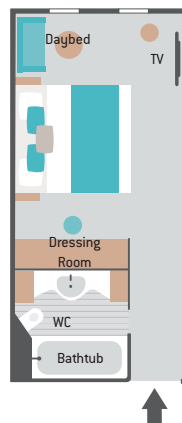
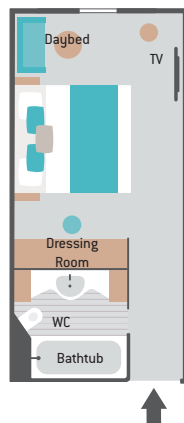
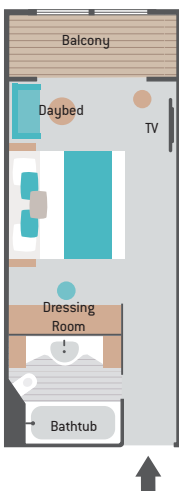

E WINDOW STATEROOM F PORTHOLE STATEROOM

(19 sq.m/200 sq.ft)
The following Window Staterooms can accommodate a guest in a sofa bed: 406, 408, 416, 418, 425, 428, 435, 436 and 438.

Take a virtual tour
of Le Paul Gauguin
at 360°

