

AVALON SUITE SHIPSSM

ROYAL SUITES, PANORAMA SUITESSM

& DELUXE STATEROOMS

STATEROOM AMENITIES

- Comfort Collection BedsSM, featuring premium memory foam mattress toppers with special construction for increased airflow and ventilation and a choice of four firmness selections – from extra firm to pillow-top soft
- Egyptian super-combed cotton linens, blankets, & European-style duvets
- Soft & firm pillows
- Choice of bed configuration – two twins or one queen or (Royal Suite only) one king
- Nightly turn-down service
- Bathrobes & slippers
- Bedside tables with reading lamps
- Large private bathroom featuring full shower with glass door, hairdryer and premium L'Occitane[®] bath products
- Spacious 3-door closets with shelves for ample storage
- Easy under-bed luggage storage
- Flatscreen satellite TV with movie channel and built-in alarm clock
- Writing desk/vanity with mirror & comfortable chair
- Complimentary Wi-Fi access
- Direct-dial telephone
- Well-stocked minibar
- USB Ports
- In-room safe
- Individual climate control
- Continental breakfast, lunch, dinner, and beverage room service available
- 11' Wall-to-Wall Panoramic Window— 50% wider than industry standard (Panorama and Royal Suites only)
- Wall-to-Wall Panoramic Window opens to create a large Open-Air BalconySM (Panorama and Royal Suites only)

ROYAL SUITES

300 SQ. FT.
ROYAL DECK

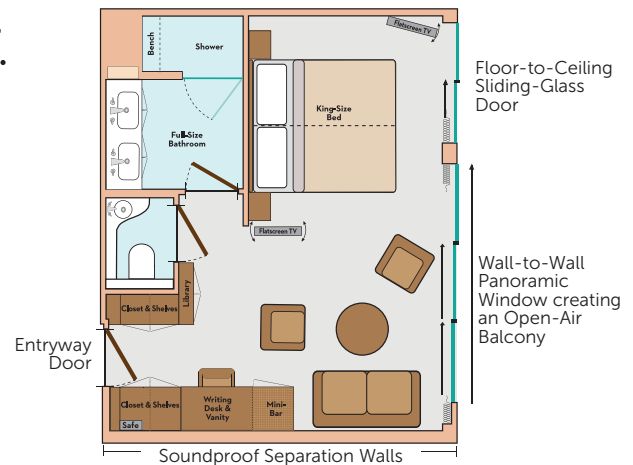

PANORAMA SUITESSM

200 SQ. FT.
ROYAL & SAPPHIRE DECKS
Category B, A, P

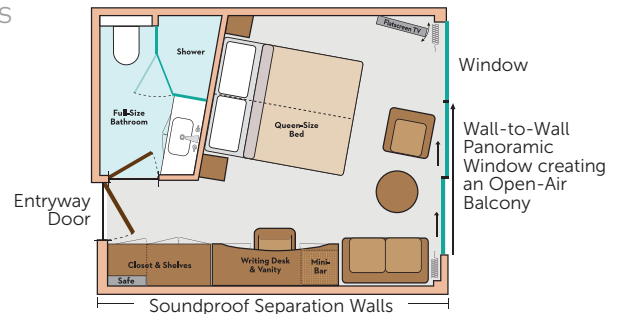

DELUXE STATEROOMS

172 SQ. FT.
INDIGO DECK
Category D & E

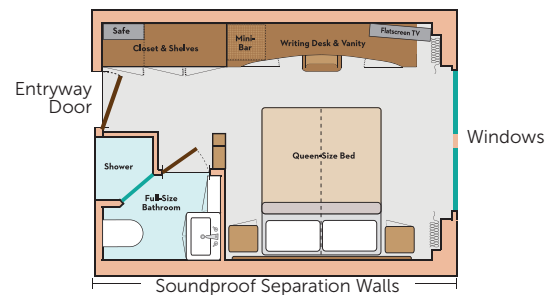

SUITES & STATEROOMS.

From spacious to cozy, you'll find the perfect space to dream. A Royal Suite or Deluxe Stateroom offers an alternative floor plan, yet with all the standard amenities of a Panorama SuiteSM. Our Royal Suite creates 300 square feet of phenomenal, including our award-winning Open-Air BalconySM. At 172 square feet, our Deluxe Staterooms are still 20% larger than the industry standard.



AVALON SUITE SHIPSSM

**AVALON VIEW® (2022), AVALON ENVISION® (2019), AVALON PASSION® (2016),
AVALON ILLUMINATION® (2014), AVALON IMPRESSIONSM (2014),
AVALON EXPRESSION® (2013), AVALON VISTASM (2012), AVALON PANORAMASM (2011)**

Passengers: 166 | Crew Members: 47 | Length: 443 ft. | Decks: 4
Royal Suites: 2 (300 sq. ft.) | Panorama SuitesSM: 65 (200 sq. ft.) | Deluxe Staterooms: 16 (172 sq. ft.)

ROYAL DECK (VIEW, ENVISION, PASSION, ILLUMINATION & IMPRESSION)



ROYAL DECK (EXPRESSION)



ROYAL DECK (VISTA & PANORAMA)

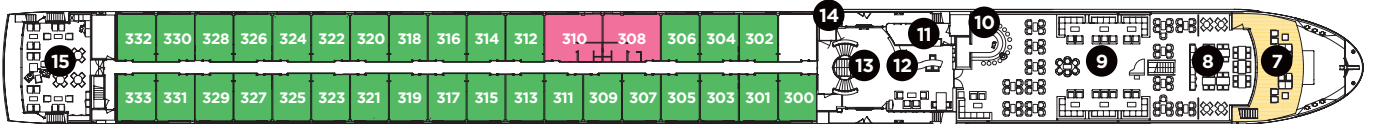

SAPPHIRE DECK (VIEW, ENVISION, PASSION, VISTA, PANORAMA, ILLUMINATION & IMPRESSION)



SAPPHIRE DECK (EXPRESSION)



INDIGO DECK (VIEW, ENVISION, PASSION, ILLUMINATION, IMPRESSION & EXPRESSION)

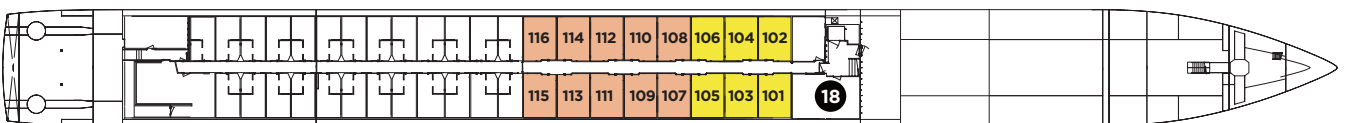

INDIGO DECK (VISTA & PANORAMA)

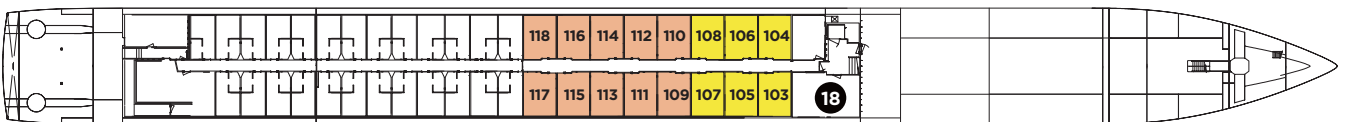

DECK PLAN

- | | | |
|----------------------|---------------------|-------------------|
| 7 Observation Lounge | 10 Bar | 15 Club Lounge |
| 8 Panorama Bistro | 11 Reception | 16 Galley |
| 9 Panorama Lounge | 12 Adventure Center | 17 Dining Room |
| | 13 Lobby | 18 Fitness Center |
| | 14 Elevator | |

CATEGORIES

- ROYAL SUITE Royal Deck | Royal Suites
- CAT. P Royal Deck | Panorama Suites
- CAT. A Sapphire Deck Forward | Panorama Suites
- CAT. B Sapphire Deck Aft | Panorama Suites
- CAT. D Indigo Deck Aft | Deluxe Staterooms
- CAT. E Indigo Deck Forward | Deluxe Staterooms

AVALON SUITE SHIPS®

AVALON IMAGERY II® (2016), AVALON TAPESTRY II® (2015),
 AVALON TRANQUILITY II® (2015), AVALON POETRY II® (2014),
 AVALON ARTISTRY II® (2013), AVALON VISIONARY (2012)

Passengers: 128 | Crew Members: 37 | Length: 361 ft. | Decks: 4
 Royal Suites: 2 (300 sq. ft.) | Panorama SuitesSM: 50 (200 sq. ft.) | Deluxe Staterooms: 12 (172 sq. ft.)

ROYAL DECK (POETRY II)

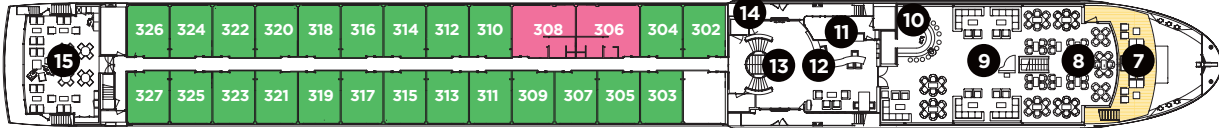

ROYAL DECK (IMAGERY II, TAPESTRY II, TRANQUILITY II, ARTISTRY II & VISIONARY)

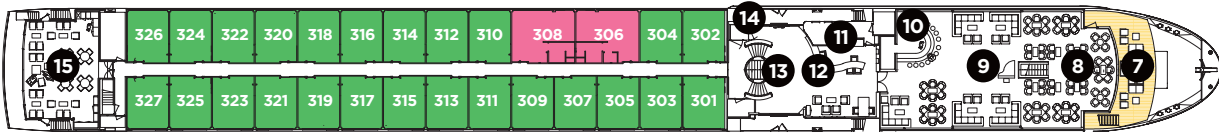

SAPPHIRE DECK (POETRY II)

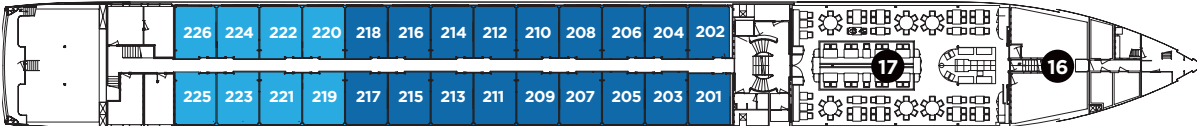

SAPPHIRE DECK (IMAGERY II, TAPESTRY II, TRANQUILITY II, ARTISTRY II & VISIONARY)

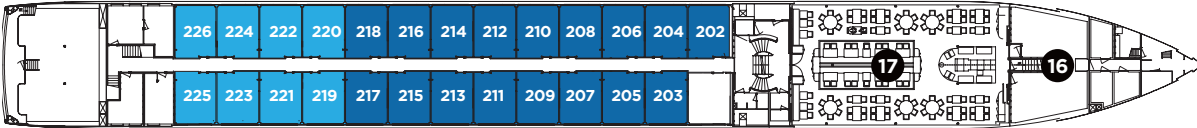

INDIGO DECK

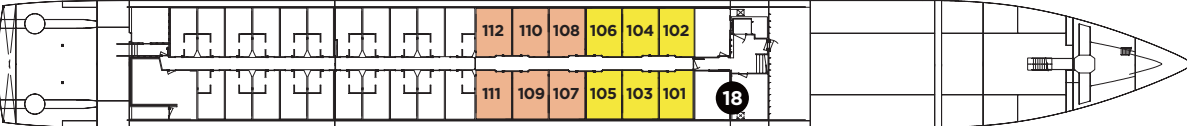

SKY DECK (ALL AVALON SUITE SHIPS)

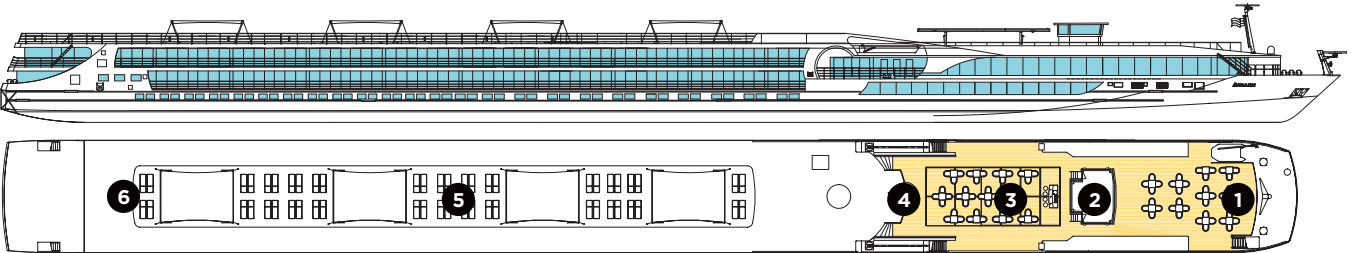

DECK PLAN

- | | | |
|---|--------------------------|---------------------|
| 1 Sky Lounge | 6 Deck Game Area | 12 Adventure Center |
| 2 Navigation Bridge | 7 Observation Lounge | 13 Lobby |
| 3 Sky Grill | 8 Panorama Bistro Lounge | 14 Elevator |
| 4 Whirlpool | 9 Panorama Lounge | 15 Club Lounge |
| 5 Premium Lounge Chairs and Shade Awnings | 10 Bar | 16 Galley |
| | 11 Reception | 17 Dining Room |
| | | 18 Fitness Center |

CATEGORIES

- ROYAL SUITE Royal Deck | Royal Suites
- CAT. P Royal Deck | Panorama Suites
- CAT. A Sapphire Deck Forward | Panorama Suites
- CAT. B Sapphire Deck Aft | Panorama Suites
- CAT. D Indigo Deck Aft | Deluxe Staterooms
- CAT. E Indigo Deck Forward | Deluxe Staterooms

CRUISING ON THE DOURO RIVER

AVALON ALEGRIASM (2024)

Passengers: 102 | Crew Members: 33 | Length: 262 ft. | Decks: 4. | Deluxe Staterooms: 14 (172 & 180 sq. ft.) | Panorama SuitesSM: 37 (200 sq. ft.)

SIDE VIEW & SKY DECK

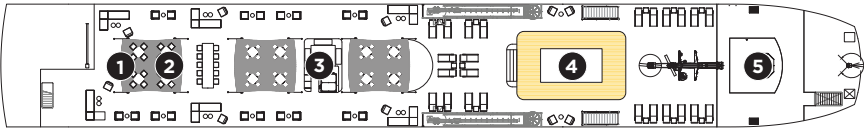
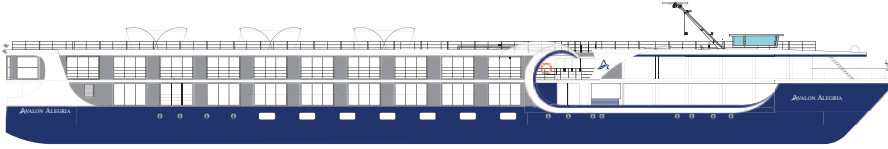

ROYAL DECK



SAPPHIRE DECK



INDIGO DECK

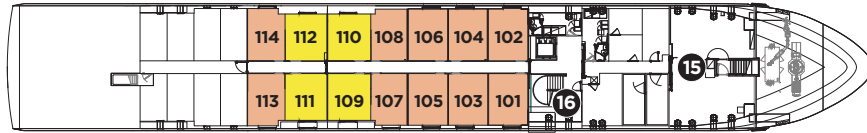

DECK PLAN

- 1 Sky Lounge
- 2 Premium Lounge Chairs and Shade Awnings
- 3 Sky Grill
- 4 Pool
- 5 Navigation Bridge
- 6 Club Lounge
- 7 Elevator
- 8 Adventure Center
- 9 Reception
- 10 Bar
- 11 Panorama Lounge
- 12 Panorama Bistro
- 13 Observation Lounge
- 14 Dining Room
- 15 Galley
- 16 Fitness Center

CATEGORIES

- CAT. P** Royal Deck | Panorama Suites
- CAT. A** Sapphire Deck Forward | Panorama Suites
- CAT. B** Sapphire Deck Aft | Panorama Suites
- CAT. D** Indigo Deck | Deluxe Staterooms
- CAT. E** Indigo Deck | Deluxe Staterooms



CATEGORY E DELUXE STATEROOM

172 SQ. FT.

INDIGO DECK

*Room configuration may vary slightly

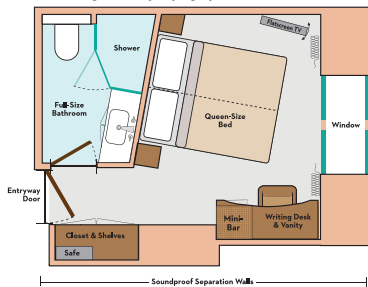

CATEGORY D DELUXE STATEROOM

180 SQ. FT.

INDIGO DECK

*Room configuration may vary slightly

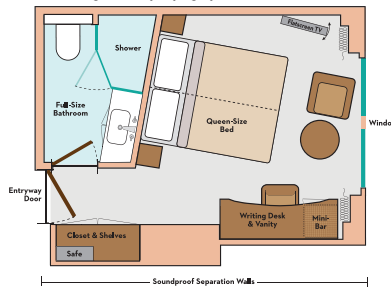

CATEGORY B, A, P PANORAMA SUITE

200 SQ. FT.

ROYAL & SAPPHIRE DECK

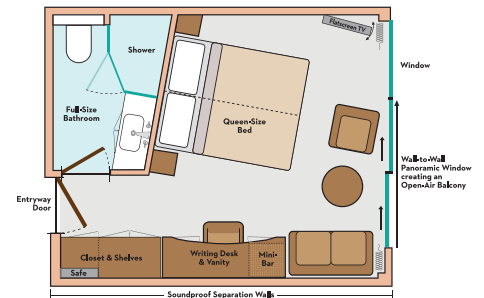

AMENITIES

- Complimentary Wi-Fi throughout the ship
- Panoramic windows throughout the ship
- Elegant, contemporary design & decor
- Friendly, English-speaking crew & Cruise Director
- Covered Observation Lounge
- Sky Deck features swimming pool, shade awnings, and premium lounges)
- Club Lounge with 24-hour self-serve beverage station with complimentary cappuccinos, lattes, tea, hot chocolate & premium coffees, as well as treats throughout the day
- Elevator
- Non-smoking interior and staterooms
- Active shore excursions, both included and optional
- Fitness Center
- Avalon Adventure Center

CRUISING ON THE MEKONG RIVER

AVALON SAIGONSM (2018)

Passengers: 36 | Crew Members: 24 | Length: 195 ft. | Decks: 2 | Suites: 18 (245 sq. ft.)

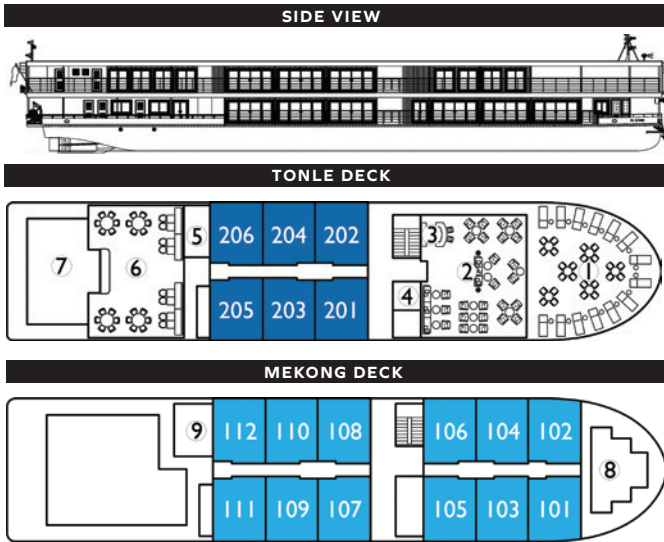

- | | | |
|--|----------------------|---------------------|
| 1 Open-air observation lounge with premium lounge chairs | 2 Panorama Lounge | 6 Dining Room |
| | 3 Bar | 7 Galley |
| | 4 Reception | 8 Navigation Bridge |
| | 5 Spa treatment room | 9 Fitness Center |

- CAT. A** Tonle Deck | Panorama Suites
- CAT. B** Mekong Deck | Panorama Suites

SHIP AMENITIES

- Air-conditioned Panorama Lounge
- Open-air observation lounge with shade system & premium lounge chairs
- Spacious, open-seating Panorama Dining Room
- Bar serving premium spirits, wine & complimentary coffee, tea, soft drinks, and local beer/spirits throughout the day
- Complimentary Wi-Fi access in the lounges (where signal is available)
- Spa treatment room
- Fitness Room
- Library and games
- Non-smoking staterooms & ship interior



PANORAMA SUITESSM

245 SQ. FT.
TONLE & MEKONG DECKS
CATEGORY A & B

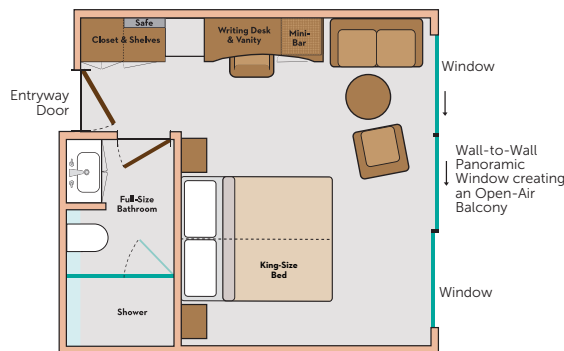

AMENITIES

- Comfort Collection BedsSM, featuring premium mattress covers
- Egyptian super-combed cotton linens, blankets & European-style duvets
- Soft & firm pillows
- Choice of bed configuration (two twins or one king)
- Nightly turn-down service
- Bedside tables with reading lamps
- 14' Wall-to-Wall Panoramic Window that opens to create a large Open-Air BalconySM
- Large private bathroom featuring full shower with glass door, hairdryer, and premium bath products
- Spacious closets with shelves for ample storage
- Easy under-bed luggage storage
- Writing desk/vanity with mirror & comfortable chair
- In-house telephone
- Bathrobes & slippers
- Complimentary water
- In-room safe
- Individual climate control



CRUISING ON THE NILE RIVER

MS FARAH (2011)

Passengers: 116 | Crew Members: 85 | Length: 236 ft. | Decks: 5 | Deluxe Stateroom: 56 (239 sq. ft.) | Royal Suite: 2 (430 sq. ft.)

SUN DECK



Swimming Pool
Barbecue Buffet
Pool Bar

WHEELHOUSE DECK

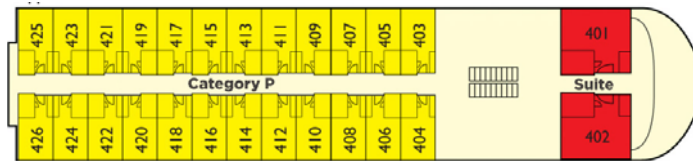

24 Staterooms
2 Suites
Gymnasium, Steam,
Sauna & Massage room

SECOND DECK



26 Staterooms
Library
Bazaar

MAIN DECK

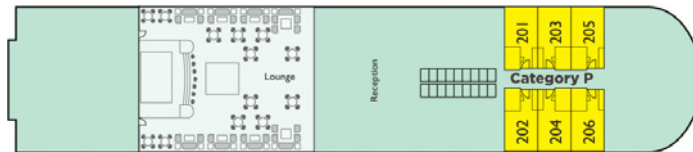

Lobby
Lounge Bar
6 Staterooms

LOWER DECK

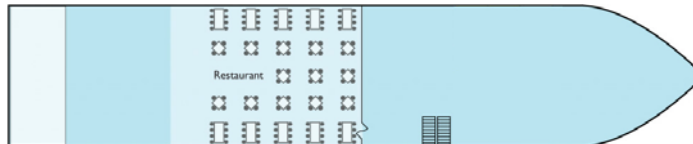

Restaurant



EXTERIOR



DELUXE STATEROOM

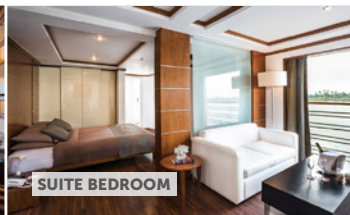

SUITE BEDROOM



ATRIUM

AMENITIES

- On board Egyptian cuisine cooking class with diploma issued by our chef.
- Pillow menu included: you will be able to choose from a range of soft, water pillow, orthopedic, and spongy pillows.
- Private safe box.
- Free use of gym - sauna and steam (massages à la carte excluded).
- All staterooms have a large panoramic window.
- Wide TV LED Screen with free cable.
- Free Wi-Fi internet connection throughout the boat.
- Telescope at disposal on the sundeck.
- Special library dedicated to Paulo Coelho.
- Welcome drink & refreshing towels upon arrival.
- Fruit basket, cookies, canapés & nuts.
- Kettle with packets of tea, Nescafé® and sugar will be served in cabins.
- The boat offers all the services and facilities needed to organise special events on board.
- Large restaurant.
- Lounge Bar.
- Pool Bar.

CRUISING THE GALÁPAGOS ISLANDS

TREASURE OF GALÁPAGOS

Passengers: 16 | Crew Members: 10 | Naturalists: 1 | Length: 102 ft. | Decks: 3 | Staterooms: 8

SUN DECK

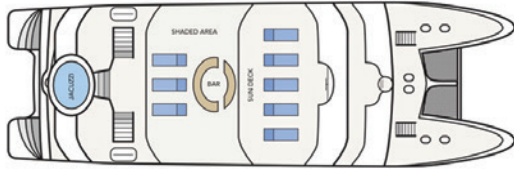

UPPER DECK

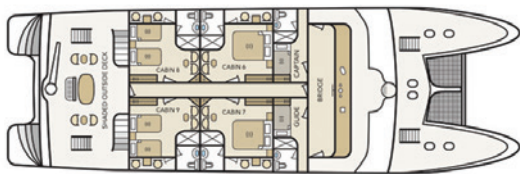

MAIN DECK

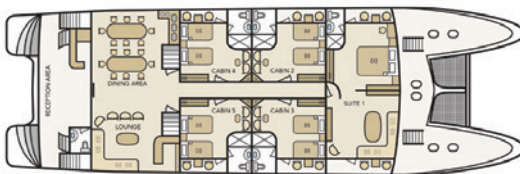

SUITE



MASTER SUITE

AMENITIES

- Twice-daily housekeeping
- Private balcony
- Bedside tables with reading lights
- Closet for storage
- Private bathroom with full shower, hairdryer and bath products
- Writing desk/vanity with mirror and comfortable chair
- 24-hour complimentary water, tea, and coffee
- In-room safe
- Individual climate control

CRUISING ON THE AMAZON RIVER

DELFIN III

Passengers: 44 | Crew Members: 24 | Naturalists: 4 | Length: 169 ft. | Decks: 3

Owner's Suite: 1 (597 sq. ft.) | Corner Suites: 2 (253 sq. ft.) | Upper Suites: 10 (237 sq. ft.) | Suites: 8 (237 sq. ft.)

PROFILE



TOP OBSERVATION DECK

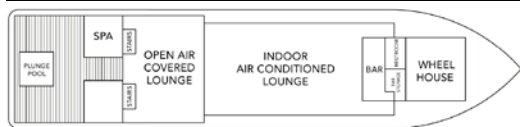

UPPER DECK

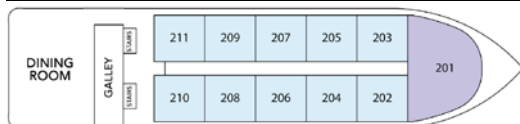

MAIN DECK

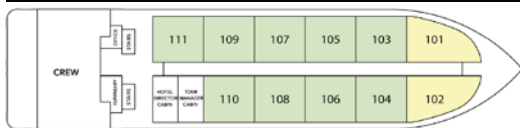

- Owner's Suite | Upper Deck
- Upper Suite | Upper Deck
- Corner Suite | Main Deck
- Suite | Main Deck



SUITE



OWNER'S SUITE

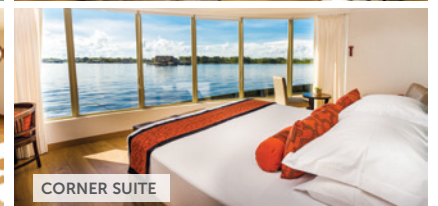

CORNER SUITE

AMENITIES

- Comfortable beds with premium mattresses
- Fine cotton linens and European-style duvets
- Pillow menu
- Choice of bed configuration (two twins or one queen in Suites and Upper Suites or king bed in Corner and Owner's Suites)
- Daily maid service with nightly turndown service
- Bedside tables with reading lamps
- Floor-to-ceiling panoramic glass windows
- Large private bathroom featuring full shower, hairdryer, makeup mirror, and premium bath amenities
- Luxury honeycomb spa robes and slippers
- Easy under-bed luggage storage and generous closet space
- Complimentary filtered water
- In-room safe
- Individual climate control